



HealthCheck

**Thank you for committing to keep your workplace safe by using
HealthCheck by Stratum™!**

To learn more about HealthCheck, please visit <https://www.stratumhealth.io/info>.

HealthCheck is available as an app (for mobile devices) or online with a desktop browser.

All answers are protected, and this application follows strict data privacy laws. The information is collected and presented in an anonymized dashboard. No one will see your answers.

However, if you have one or more symptoms, the administrator for your group will be sent an email advising them of the result of the screening. Your administrator will not know which symptom triggered the alert. This process helps ensure users of the app are safe, can find local health facilities, and can adjust work schedules as needed for the safety of everyone.

The process is simple and takes under one minute. EVERY DAY prior to leaving home, log in to the HealthCheck portal on your mobile device or any browser and answer a series of yes/no questions. You will also need to enter your current temperature.

At the end of the screening, you will receive one of three results:

Green = eligible to come onsite. Please be prepared to scan your QR code for entry to the building.

Yellow = you will not be allowed to come on site. Stay home and follow up with your administrator.

Red = You will not be allowed to come on site. Consult your medical provider and follow up with your administrator.

STEP 1. GETTING STARTED

Download the HealthCheck by Stratum app or use the web interface at:
<https://healthcheck.stratumhealth.io>



STEP 2. REGISTER AS A NEW USER

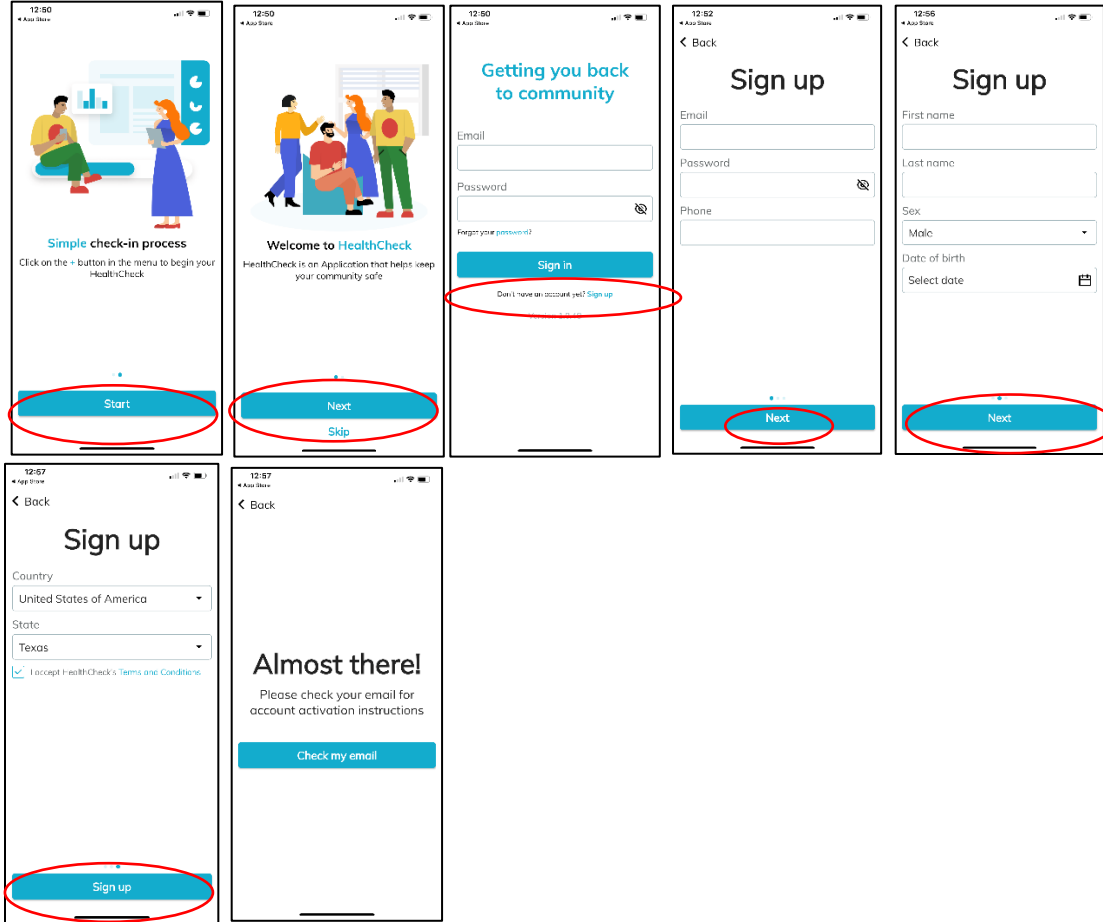

STEP 3. CHECK YOUR EMAIL - ACTIVATE ACCOUNT WITH THE LINK

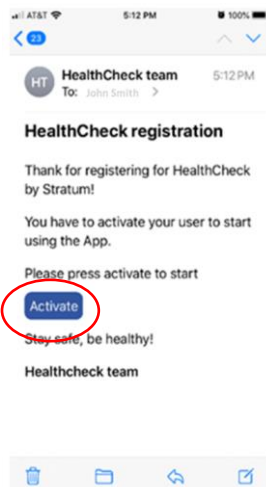

STEP 4. REGISTER WITH YOUR FACILITY (Department):

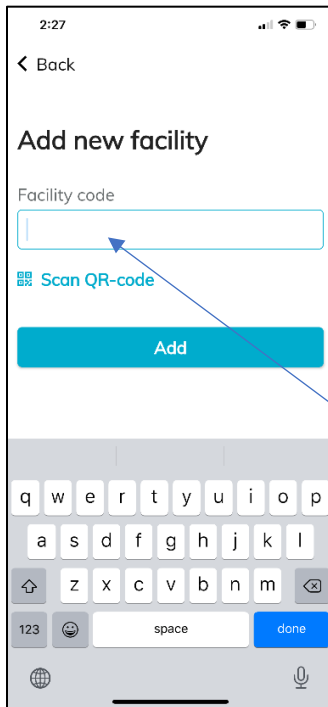
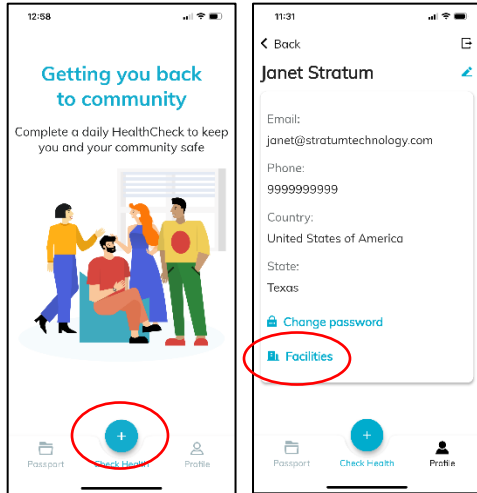

You will insert the code associated with your work location or department (FACILITY) in the box. YOUR CODE IS:

Department	Facility	Facility Code
AAADT Dancers and Stage Managers	AAADT	LUGeJC5R
AAADT Crew	Ailey Warehouse	pCqhJmX6
Ailey School Faculty/Musicians	School Faculty/Musicians	ENJOHkZ6
Ailey II Dancers and Crew	Ailey II	32JxcwA0

Arts in Education/AileyCamp Teaching Artists and Musicians	AIE	QOFqJdth
Ailey School Junior Division	School JD Students	1OCPsnQt
Ailey School Professional Division (including BFA)	School PD Students	RczLslhw
Ailey School PPAS	School PPAS	ODKI93WM
Full Time and Part Time Administrative Staff	Ailey Staff	bl1h+dry
Part Time Studio Managers/Theater Technicians	Studio Operations	BOs/S6B5
Ailey Extension Teaching Artists and Musicians	Extension	/pxXRZ0N

NOTE: If you work in more than one area, please use the facility code for the department you're working for that day.

STEP 5. COMPLETE DAILY HEALTHCHECK PRIOR TO GOING TO WORK

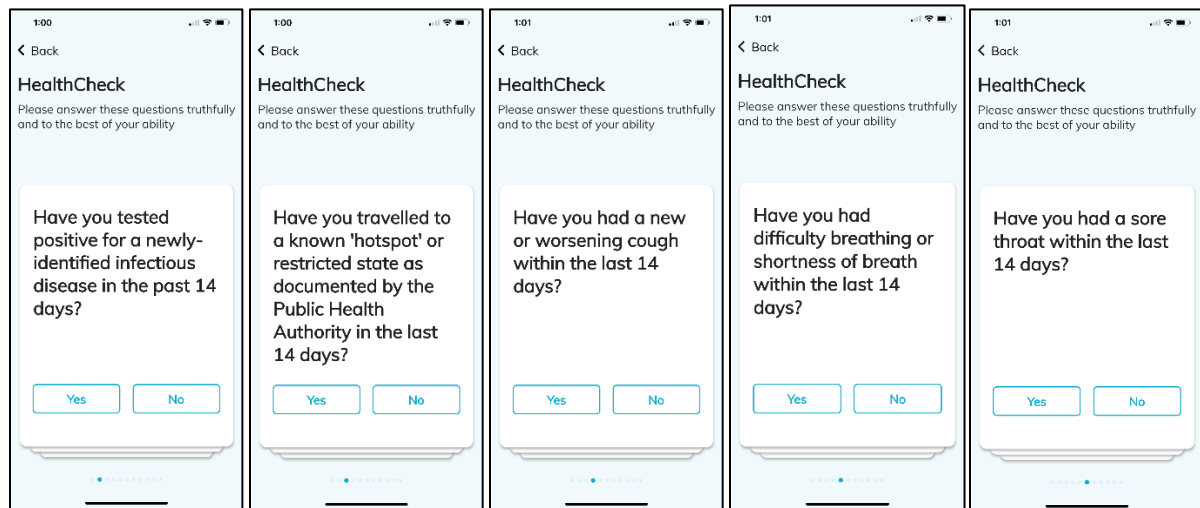

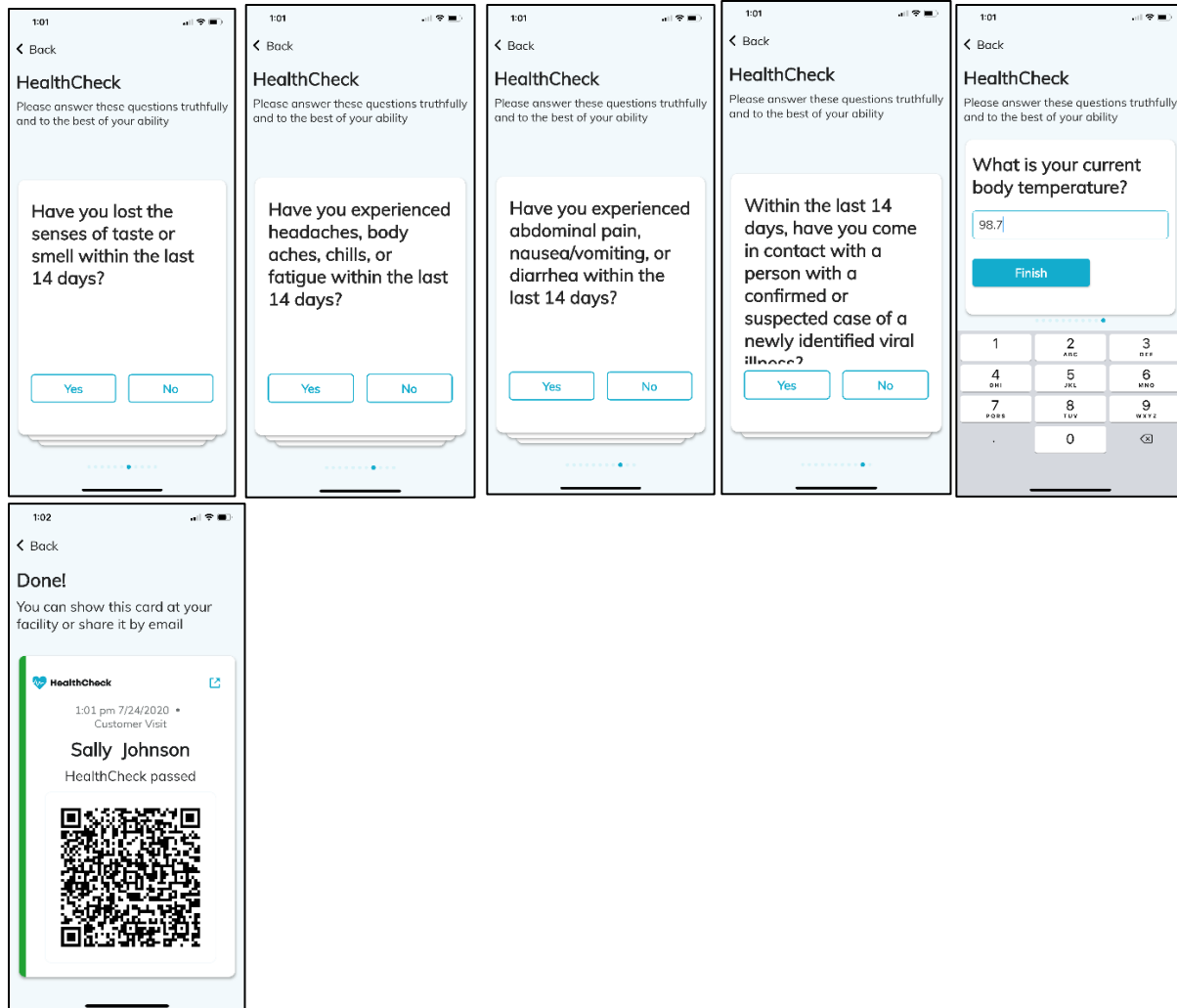

You're done! Congrats on completing your registration and first HealthCheck! For any issues with facilities, please contact support@stratumhealth.io.

STEP 6. SCAN YOUR QR CODE AND ENTER THE BUILDING

- Open the HealthCheck app and tap **"Passport"**
- Tap the most recent **"HealthCheck passed"** entry to display the QR code
- Scan the code on the iPad located inside the front entrance

STEP 7. SCAN YOUR QR CODE WHEN EXITING THE BUILDING

- Open the HealthCheck app and tap **"Passport"**
- Tap the most recent **"HealthCheck passed"** entry to display the QR code
- Scan the code on the iPad located near the exit doors

You can also access HealthCheck via any web browser using the instructions below.

NOTE: you don't need to do this if you're going to use the app to sign in and complete your daily health check. It's just another way to access the HealthCheck system should you need it.

USING THE WEB APP TO REGISTER AND COMPLETE SCREENINGS

1. Go to <https://healthcheck.stratumhealth.io> and click **Sign Up**:

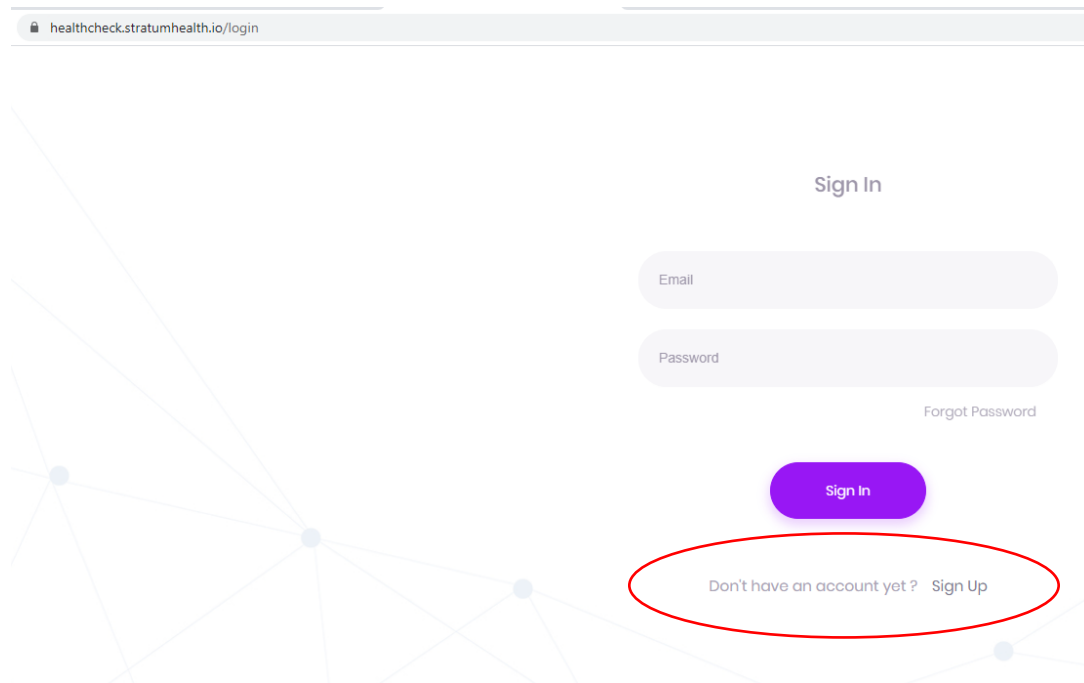

2. Complete the Sign Up form and insert the facility code that you wish to register with:

Sign Up
Enter your details to create your account:

* All fields are required

Email

Password
*At least 6 symbols are required

First Name

Last Name

Select your age

Male Female

Phone number

Facility code

Select country

EULA check

Sign Up Cancel

Insert appropriate facility code here

Organization	Facility	Facility Code
Alvin Ailey American Dance Theater	AAADT	LUGeJC5R
Alvin Ailey American Dance Theater	Ailey Warehouse	pCqhJmX6
Alvin Ailey American Dance Theater	School Faculty/Musicians	ENJOHkZ6
Alvin Ailey American Dance Theater	Ailey II	32JxcwA0
Alvin Ailey American Dance Theater	AIE	QOFqJdth
Alvin Ailey American Dance Theater	School JD Students	1OCPsnQt
Alvin Ailey American Dance Theater	School PD Students	RczLslhw
Alvin Ailey American Dance Theater	School PPAS	ODKI93WM
Alvin Ailey American Dance Theater	Ailey Staff	bl1h+dry
Alvin Ailey American Dance Theater	Studio Operations	BOs/S6B5
Alvin Ailey American Dance Theater	Extension	/pxXRZ0N

3. Once registered, please go to your email account and click Activate in the email from **HealthCheck team**:

ACTIVATE ACCOUNT WITH EMAIL LINK

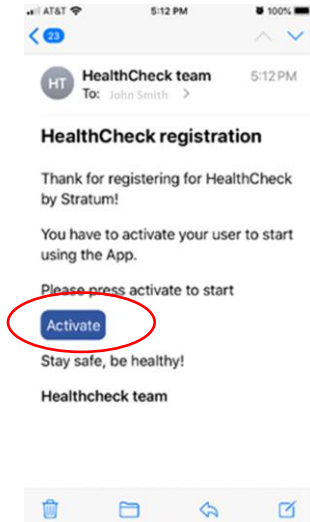

4. Download the app in the [Apple App Store](#) or the [Google Play Store](#) or use the web interface at: <https://healthcheck.stratumhealth.io>.
5. Login from either the app or website and perform HealthChecks daily before attending work.